



Product Information **EZ-LINE EZ-LINE Transwell Cell Culture Inserts**

Product information for SP46117, SP46135:

Description

Bio Basic EZ-LINE Transwell inserts closely mimic *in vivo* environments, providing improved attachment, growth and differentiation of various cell types. With their permeable properties, these inserts are a convenient and effective tool for a wide range of research areas, including transportation and invasion studies. Specially selected track-etched membranes of 0.4 μm are used for these inserts. Track-etched membranes ensure precise pore size distribution and consistent pore density, providing well-controlled experimental parameters.



Features:

- Distance from membrane to the bottom of the well: 6well Insert 1.2mm, 24well Insert 1.3mm
- Nominal membrane thickness: 10 ~ 23 μm
- Frame material: Polystyrene (PS)
- Packed in cell culture-treated cell culture plates (Please see product info for **SP41117** and **SP41135**)

Item No.	Description	Package
SP46117	EZ-LINE Transwell cell culture insert, 6well	24/case
SP46135	EZ-LINE Transwell cell culture insert, 24 well	48/case



Technical Specifications

Item No.	SP46117	SP46135
Quantity per case	24/case	48/case
Packaging	6 inserts/6-well plate	12 inserts/24-well plate
Membrane	Polycarbonate	Polycarbonate
Membrane Pore Size (um)	0.4	0.4
Membrane Diameter (mm)	24	6.5
Growth Area (cm ²)	4.52	.33
Working volume (ml)	1.5-2.5	0.2-0.35
Optical Properties	Opaque	Opaque
Sterile	Yes	Yes

Storage

Room temperature.

SPECIFICATIONS: SP46117 EZ-LINE Transwell cell culture insert, 6well

Membrane		Dimensions		Material (Resin)	Packaging
		Frame			
		Upper	Lower		
Diameter:	25.00 mm	Diameter _{Outer} :	28.00 mm	<ul style="list-style-type: none"> • Membrane: Polycarbonate (PC) or Polyethylene terephthalate (PET) • Frame: Polystyrene (PS) 	<ul style="list-style-type: none"> • Pieces/Sleeve: 6 • Pieces/Case: 24
Thickness:	7 ~ 10 µm	Diameter _{Inner} :	26.65 mm		
Pore Size:	0.4 µm				
Height:		16.80 mm			
Growth Area:		4.52 cm ²			
Working Volume per Insert:		1.50 ~ 2.50 ml			

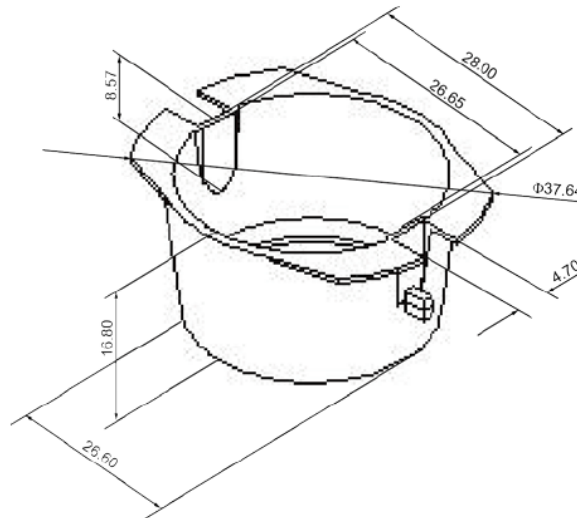



SPECIFICATIONS: SP46135 EZ-LINE Transwell cell culture insert, 24 well

Membrane	Dimensions		Material (Resin)	Packaging
	Frame			
	Upper	Lower		
Diameter: 6.50 mm Thickness: 7 ~ 10 µm Pore Size: 0.4 µm	Diameter _{Outer} : 10.68 mm Diameter _{Inner} : 9.54 mm	Diameter _{Outer} : 9.46 mm Diameter _{Inner} : 6.48 mm	• Membrane: Polycarbonate (PC) or Polyethylene terephthalate (PET)	• Pieces/Sleeve: 12 • Pieces/Case: 48
Height: 16.80 mm Growth Area: 0.33 cm ² Working Volume per Insert: 0.20 ~ 0.35 ml			• Frame: Polystyrene (PS)	

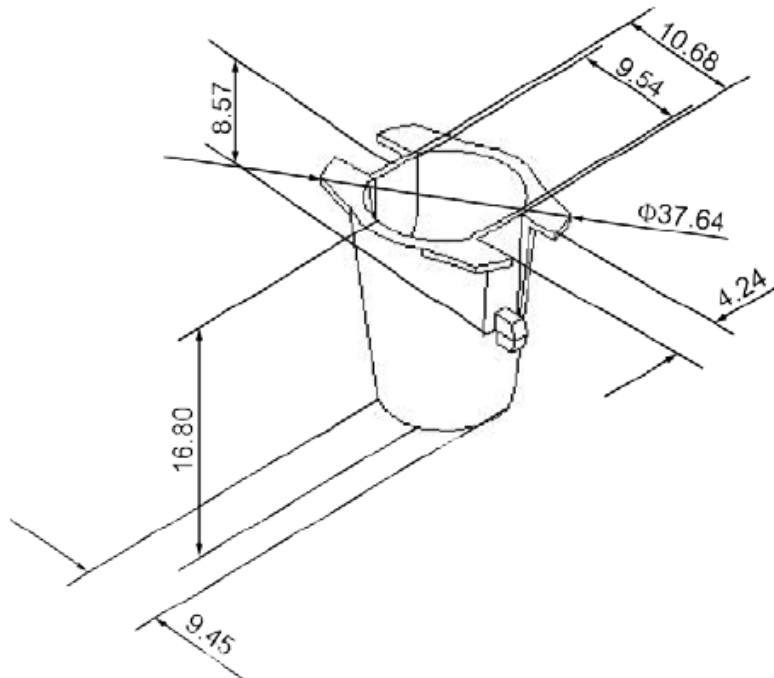



Certificate of Compliance

Product Description: Cell culture products
Expiration Date: 5 years from manufacture date

Visual Attribute: PASS
Functional Test: PASS
Sterilization: Sterilization was performed by exposed gamma irradiation according to ISO 11137 based on the *Sterilization of healthcare products-Requirements for validation and routine control-Radiation sterilization <SAL 10-6>*
Cytotoxicity Test: Cytotoxicity test is conducted to qualify all material resins using USP class VI<87> and/or ISO 10993 standards for cytotoxicity and have been shown to be non-toxic
Pyrogens Test: Non-pyrogenic tested according to the principles of the LAL test described in USP<85>/ 0.5EU/ml
RNase/DNase Test: This product has been tested and is free of any detectable RNase/DNase contamination

- ✓ Bio Basic Inc. hereby certifies that the products identified above have been manufactured & inspected in compliance with products quality specifications and requirements as documented in our ISO 9001:2008 Quality Management System.